



200-bed Adult In-Patient Hospital In-Patient Garden

COPYRIGHT:
 The design and details shown on this drawing are applicable to The Named Project only and may not be; reproduced, modified or relayed in whole or part or be used for any other project or purpose without the prior written permission of TOT Architects with whom copyright resides.

DO NOT SCALE this drawing. Use figured dimensions only. The Contractor is responsible for checking all levels and dimensions on site prior to commencement of works. Any discrepancies are to be referred to the ARCHITECT.

Drawings to be read in conjunction with all other Consultants Drawings & Specifications were relevant. Proprietary items shall be fixed in strict accordance with the Manufacturer's Instructions. Sizes of proprietary items shall be checked with Manufacturer.

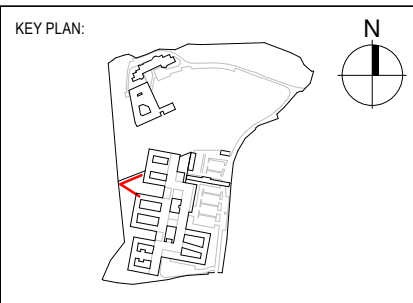

DATE	REV	DESCRIPTION
17/04/26	0	ISSUED FOR PLANNING

REVISIONS:

DATE	REV	DESCRIPTION
17/04/26	0	ISSUED FOR PLANNING

TOT ARCHITECTS

REGISTERED OFFICE
 49 Upper Mount Street
 Dublin 2, D02 FR85, Ireland

T +353 1 705 7800
 W www.totarch.ie
 E info@totarch.ie

CLIENT:	SPUH
PROJECT:	St Edmundsbury Hospital Lucan
PROJECT STAGE :	Planning
DRAWING TITLE:	CGI - Main Hospital External View - In Patient Garden 2

DRAWN:	MA	CHECKED:	LC	APPROVED:	DS	DATE:	17/04/2026
JOB NUMBER:	20-77	SHEET SIZE:	A3 L	SCALE:			
INFORMATION CONTAINER IDENTIFICATION:				SPMHS - Z - ZZZ - IM - TOT - AR - 7004			
ACCEPTANCE CODE:	S	PURPOSE CODE:	P3	REVISION:			
				0			